

Compact 3/2 normally closed metal bodied valves with push-in air connections. Designed for the process duty cycle with high durability. Ideal for the process or packaging industry.

- High durability
- Very good repeat accuracy
- Design for process duty cycle
- Push-in connection
- Versatile and easily maintained
- Miniature size

 **For ATEX specific products contact Sales Office**



**Operating information**

Working pressure; PXC-M	3 to 8 bar		
Working temperature	-15 °C to +60 °C		
<b>PXC-M111</b>	<b>PXC-M121</b>	<b>PXC-M521</b>	<b>PXC-M601</b>
Flow (Qmax):	60 l/min	85 l/min	250 l/min 250 l/min
For more information see <a href="http://www.parker.com/euro_pneumatic">www.parker.com/euro_pneumatic</a>			

**Bore Ø1,5 mm, flow 60 NI/min**

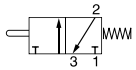
Symbol	Actuator	Return at 6 bar, N	Operating forces	Order code
	Steel plunger	Spring	11	<b>PXC-M111</b>

**Bore Ø1,5 mm, flow 85 NI/min**

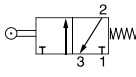
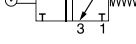
Symbol	Actuator	Return at 6 bar, N	Operating forces	Order code
	Plastic roller	Spring	4,5	<b>PXC-M121</b>
	Steel roller	Spring	4,5	<b>PXC-M131</b>

**Bore Ø2,5 mm, flow 250 NI/min**

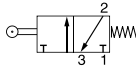
Symbol	Actuator	Return at 6 bar, N	Operating forces	Order code
	Plastic roller	Spring	7	<b>PXC-M521</b>

**3/2 compact limit switches -**

With Ø4mm Push-in connections with pipeable exhaust port

**Bore Ø2,5mm, flow 250 NI/min - With plunger head**

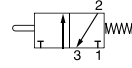
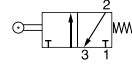
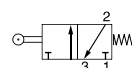
Symbol	Actuator	Return at 6 bar, N	Operating forces	Order code
	Steel plunger	Spring	24	<b>PXC-M601A110</b>
	Steel roller plunger	Spring	24	<b>PXC-M601A102</b>
	90° Steel roller plunger	Spring	24	<b>PXC-M601A103</b>

**Dimensions, Limit switches, Series PXC**

All dimensions in mm unless otherwise stated

**3/2 miniature limit switches**

**PXC-M111      PXC-Z12      PXC-Z11**

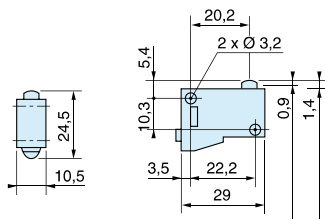

**PXC-M121 - PXC-M131**

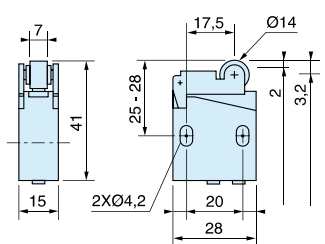

**PXC-M521**

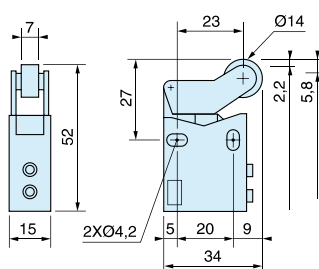

**3/2 compact limit switches**

**PXC-M601A102      PXC-M601A103**

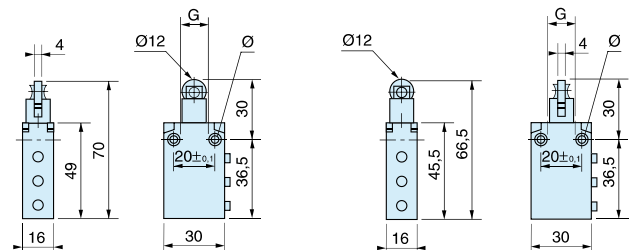

**PXC-M601A110**

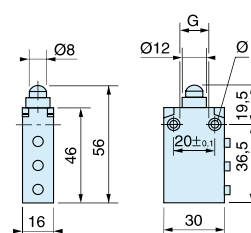

Ergonomically designed units to provide protection against accidental operation of machines. Completely sealed units prevent tampering and comply with latest European safety standards.

- Ergonomic design
- Robust polymer or metal enclosure
- Meets requirements for protection against accidental operation and tampering
- Metal enclosure features a wrist-rest bar which helps prevent illness due to repetitive actions
- Conforms to EN574 and EN954-1 requirements



**Operating information**

Working pressure	3 to 8 bar
Working temperature	-5 °C to +60 °C
For more information see <a href="http://www.parker.com/euro_pneumatic">www.parker.com/euro_pneumatic</a>	

**Control module only**

Symbol	Connections	Order code
	Ø4 mm Push-in	<b>PXP-A11</b>

**Complete units**

Polymer enclosure, with two Ø40 mm push button with protective guards and control module

Symbol	Connections	Number of control modules	Order code
	Ø4 mm Push-in	1	<b>PXP-C111</b>
	Ø4 mm Push-in	2	<b>PXP-D121</b>

Metal enclosure, with two Ø60 push buttons, wrist restbar, built in protective guard and control module

Symbol	Connections	Number of control modules	Order code
	Push-in Ø6 mm for supply Ø4 mm for output	1	<b>PXP-S111</b>
	Push-in Ø6 mm for supply Ø4 mm for output	2	<b>PXP-S121</b>

**Dimensions**

**PXP-A11**

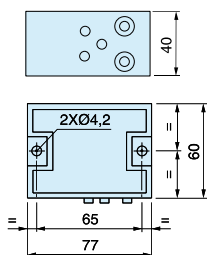

**PXP-C111 and PXP-D121**

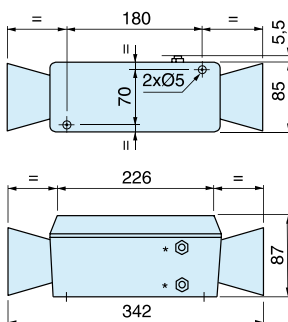

**PXP-S111 and PXP-S121**

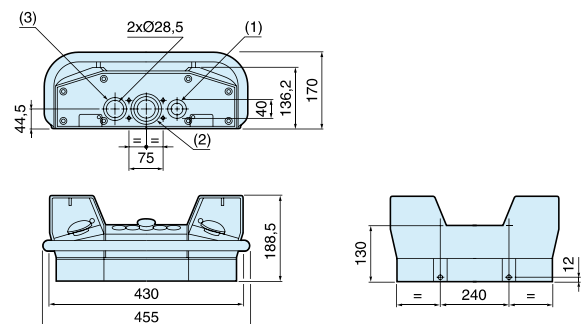

\* Ø4 mm push-in connections  
\*\* Ø6 mm push-in connections